

NOTES (UNLESS OTHERWISE SPECIFIED):

1. CAD MODEL _____ REV. ____ IS
REQUIRED TO COMPLETE PRODUCT
DEFINITION.
2. DIRECTLY-TOLERANCED DIMENSIONS
AND BASIC DIMENSIONS DEFINED ON
THE DRAWING TAKE PRECEDENCE
OVER DIMENSIONAL DATA DEFINED BY
THE MODEL. OBTAIN ALL OTHER
DIMENSIONAL DATA FROM THE MODEL.
THE MODEL REPRESENTS BASIC
DIMENSIONAL DATA UNLESS
OTHERWISE SPECIFIED.
3. APPLICABLE STANDARDS:
ASME Y14.41-2003 APPLIES TO
DATASET AND MOVABLE DATUM
TARGETS.

ASME Y14.5M-1994 APPLIES TO
DIMENSIONING AND TOLERANCING.
4. FULL DIAMETER OF EACH INDICATED
HOLE MUST INTERSECT WITH THE
CROSS-DRILLED HOLE AT ITS BOTTOM.
INDICATED HOLES MUST NOT CONTACT
FAR SIDE OF CROSS- DRILLED HOLES.
5. $\square 1.5 | A | B | C$ APPLIES TO ALL
UNTOLERANCED SURFACES.
6. UNITS: MILLIMETERS

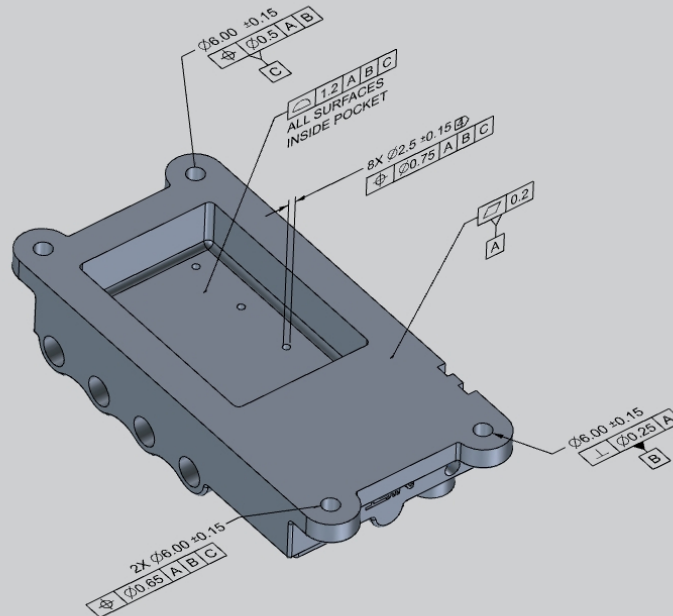

FILE_NAME: STC_10

Units: mm

Use the view carousel to the left
to view MBD saved view configurations.

Note: You must enable 3D content viewing to
activate a saved view.

NOTES (UNLESS OTHERWISE SPECIFIED):

1. CAD MODEL _____ REV. ____ IS REQUIRED TO COMPLETE PRODUCT DEFINITION.
2. DIRECTLY-TOLERANCED DIMENSIONS AND BASIC DIMENSIONS DEFINED ON THE DRAWING TAKE PRECEDENCE OVER DIMENSIONAL DATA DEFINED BY THE MODEL. OBTAIN ALL OTHER DIMENSIONAL DATA FROM THE MODEL. THE MODEL REPRESENTS BASIC DIMENSIONAL DATA UNLESS OTHERWISE SPECIFIED.
3. APPLICABLE STANDARDS:
ASME Y14.41-2003 APPLIES TO DATASET AND MOVABLE DATUM TARGETS.

ASME Y14.5M-1994 APPLIES TO DIMENSIONING AND TOLERANCING.
4. FULL DIAMETER OF EACH INDICATED HOLE MUST INTERSECT WITH THE CROSS-DRILLED HOLE AT ITS BOTTOM. INDICATED HOLES MUST NOT CONTACT FAR SIDE OF CROSS- DRILLED HOLES.
5. $\boxed{\text{1.5}} \boxed{A} \boxed{B} \boxed{C}$ APPLIES TO ALL UNTOLERANCED SURFACES.
6. UNITS: MILLIMETERS

